

PROPOSED NEW DEVELOPMENT MASTERPLAN
FOR
DIXIE MAYFIELD/HWY. 410 INDUSTRIAL PARK
CALEDON, ONTARIO

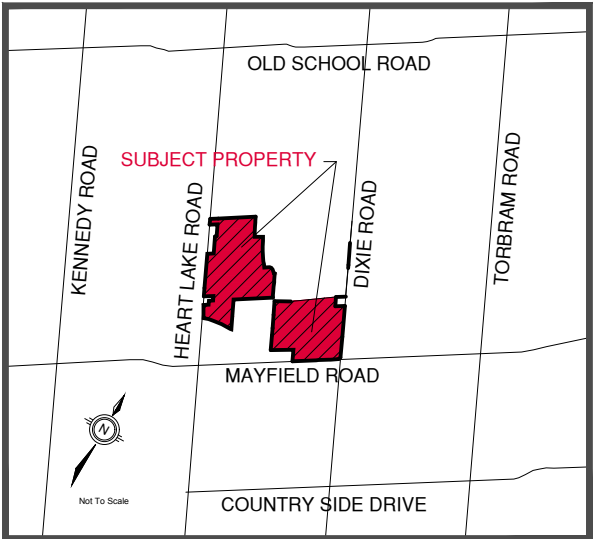

KEY MAP - N.T.S.

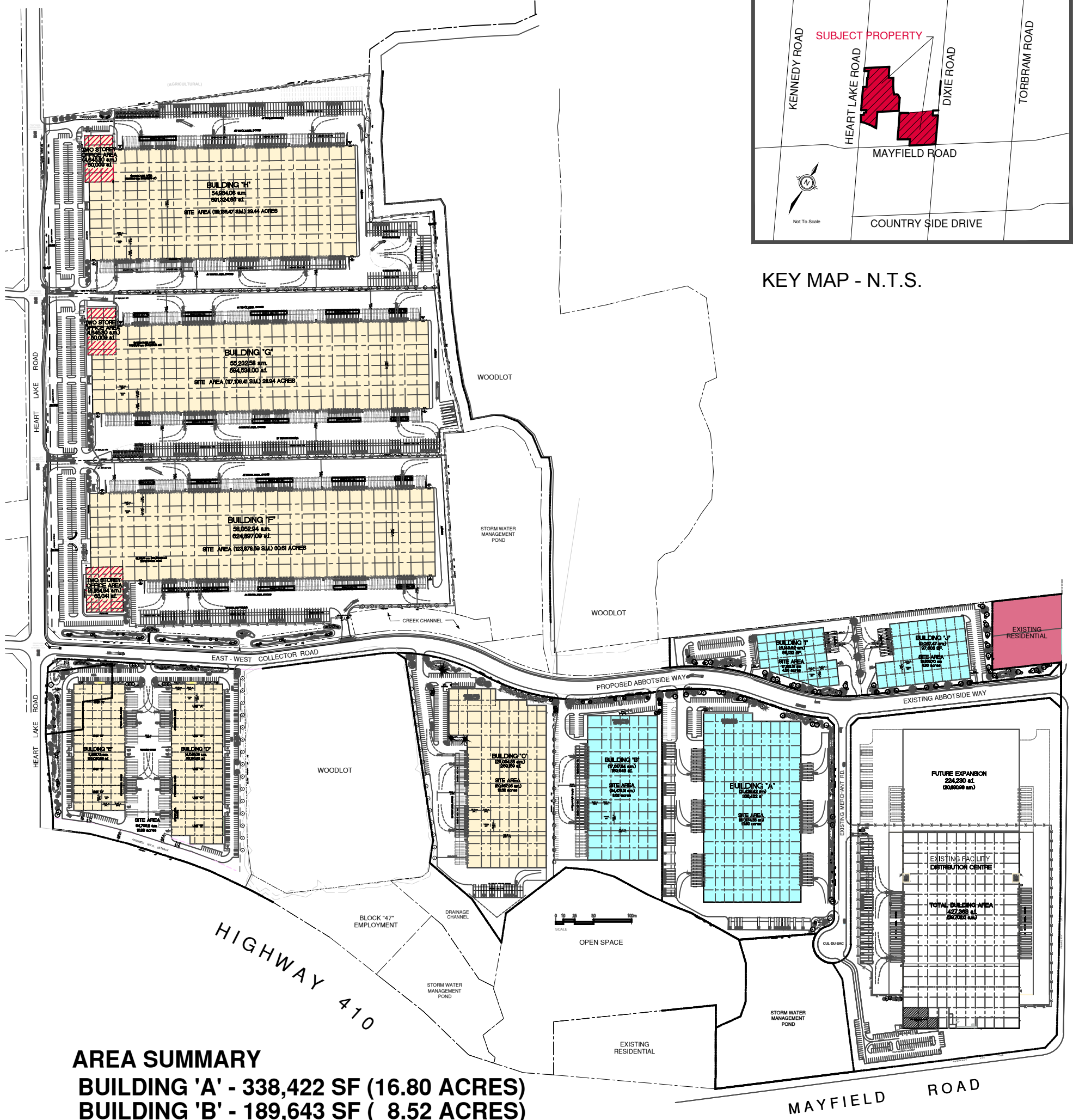

AREA SUMMARY

- BUILDING 'A' - 338,422 SF (16.80 ACRES)**
- BUILDING 'B' - 189,643 SF (8.52 ACRES)**
- BUILDING 'C' - 269,159 SF (12.52 ACRES)**
- BUILDING 'D' - 151,196 SF**
- BUILDING 'E' - 122,021 SF**
- BUILDING 'F' - 624,897 SF (32.97 ACRES)**
- BUILDING 'G' - 594,538 SF (31.30 ACRES)**
- BUILDING 'H' - 591,325 SF (31.80 ACRES)**
- BUILDING 'I' - 66,132 SF (4.25 ACRES)**
- BUILDING 'J' - 97,605 SF (4.90 ACRES)**
- TOTAL AREA - 3,044,938 SF (159.05 ACRES)**

LEGEND

- BUILDING LOCATED ON PROPERTY WITHIN NORTHWEST GTA CORRIDOR IDENTIFICATION STUDY AREA. PROPERTY MAY BECOME AVAILABLE UPON COMPLETION OF STUDY.
- BUILDING LOCATED ON PROPERTY RELEASED FROM GTA WEST CORRIDOR STUDY AREA. PROPERTIES CURRENTLY AVAILABLE FOR DEVELOPMENT.

PRELIMINARY



CONTEXT SITE PLAN LAYOUT
SCALE : AS SHOWN