

PROPOSED NEW DEVELOPMENT MASTERPLAN FOR DIXIE MAYFIELD/HWY. 410 INDUSTRIAL PARK WEST CALEDON, ONTARIO

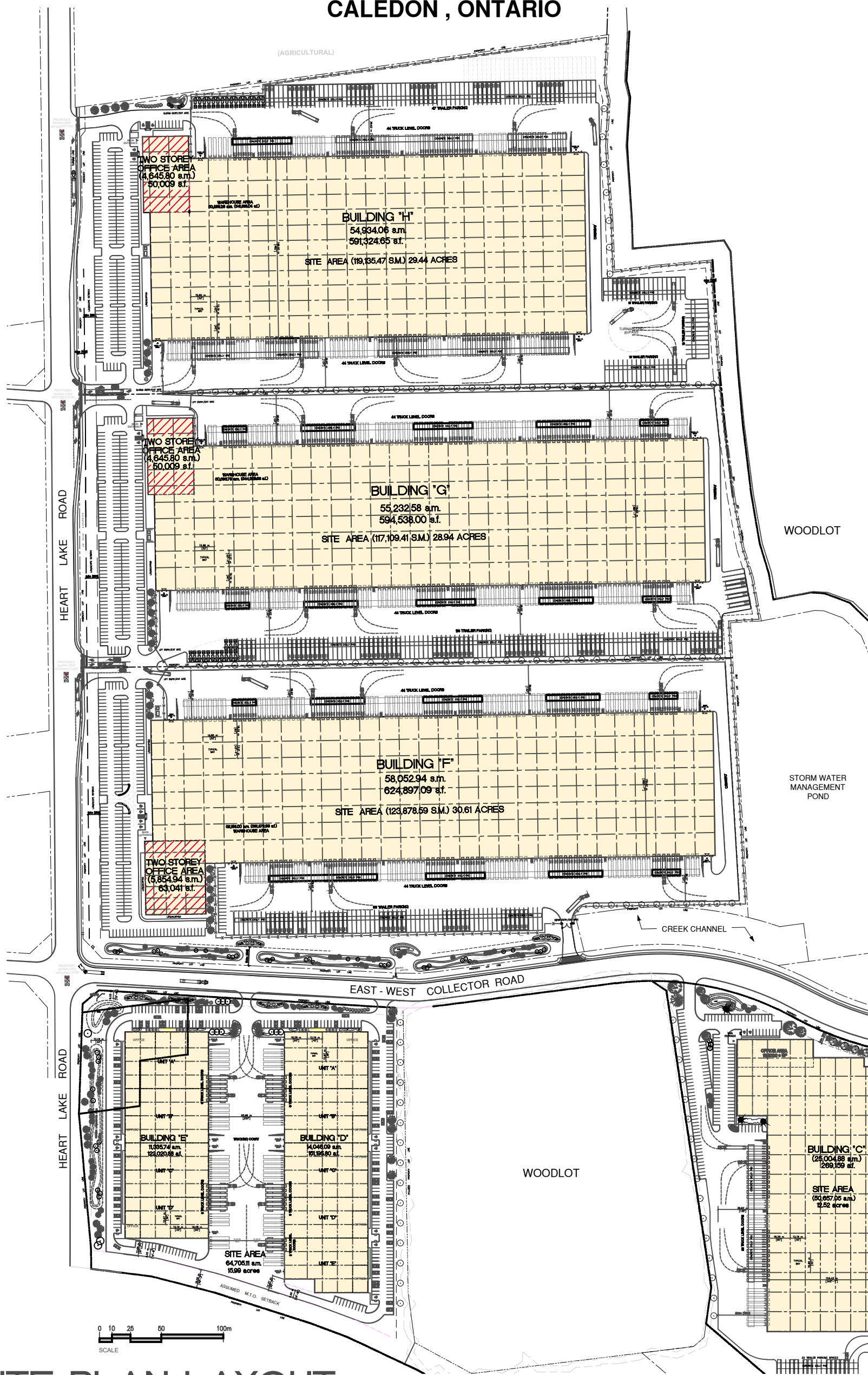

SITE PLAN LAYOUT

SCALE : AS SHOWN

LEGEND

- BUILDING LOCATED ON PROPERTY WITHIN NORTHWEST GTA CORRIDOR IDENTIFICATION STUDY AREA. PROPERTY MAY BECOME AVAILABLE UPON COMPLETION OF STUDY.
- BUILDING LOCATED ON PROPERTY RELEASED FROM GTA WEST CORRIDOR STUDY AREA. PROPERTIES CURRENTLY AVAILABLE FOR DEVELOPMENT.

PRELIMINARY

AREA SUMMARY

- BUILDING 'D' - 151,196 SF**
- BUILDING 'E' - 122,021 SF**
- BUILDING 'F' - 624,897 SF (32.97 ACRES)**
- BUILDING 'G' - 594,538 SF (31.30 ACRES)**
- BUILDING 'H' - 591,325 SF (31.80 ACRES)**