

**PROPOSED NEW INDUSTRIAL FACILITIES
FOR
DIXIE MAYFIELD/HWY. 410 INDUSTRIAL PARK EAST
CALEDON, ONTARIO**

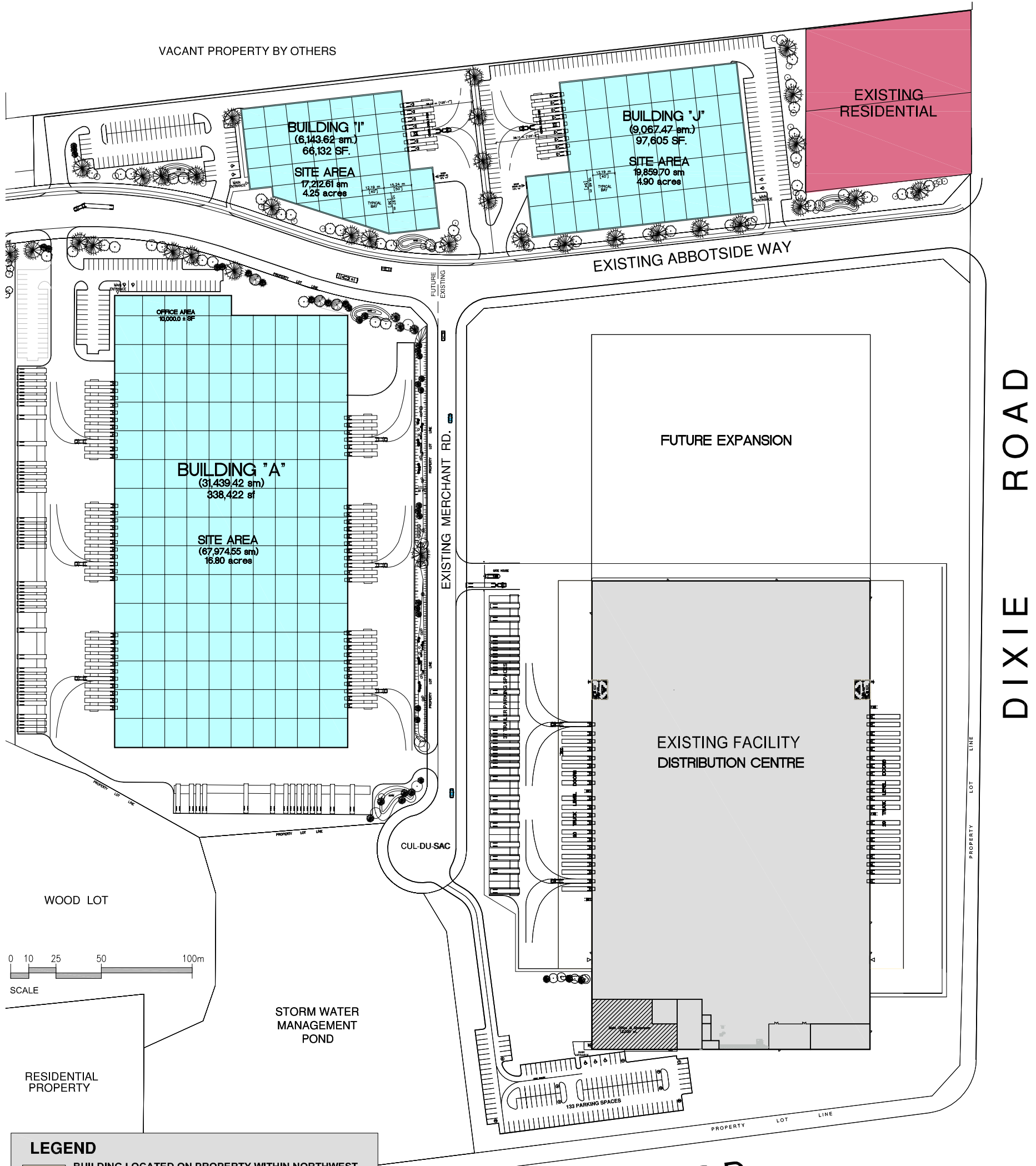

LEGEND

- BUILDING LOCATED ON PROPERTY WITHIN NORTHWEST GTA CORRIDOR IDENTIFICATION STUDY AREA. PROPERTY MAY BECOME AVAILABLE UPON COMPLETION OF STUDY.
- BUILDING LOCATED ON PROPERTY RELEASED FROM GTA WEST CORRIDOR STUDY AREA. PROPERTIES CURRENTLY AVAILABLE FOR DEVELOPMENT.

SITE PLAN LAYOUT
SCALE : AS SHOWN

MAYFIELD RD.

AREA SUMMARY

BUILDING 'A'	- 338,422 SF (16.80 AC)
BUILDING 'I'	- 66,132 SF (4.25 AC)
BUILDING 'J'	- 97,605 SF (4.90 AC)

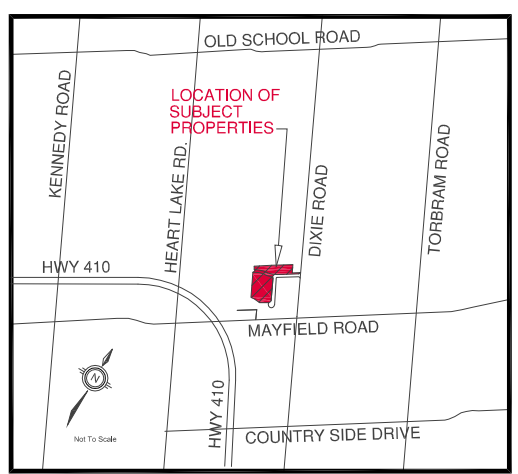

PRELIMINARY

